

TECHNICAL DATA

SINGLE DIRECTION VIBRATORY PLATES

BVP 10/30, BVP 12/50 A



Handling

103.6 lb lightweight (BVP10/30)
158.7 lb lightweight (BVP12/50A)



Performance

Fast running and simple handling



Costs

Maintenance free exciter (BVP10/30)

Shipping dimensions in cub.yd

BVP 10/30	0,146
BVP 12/50 A	0,328

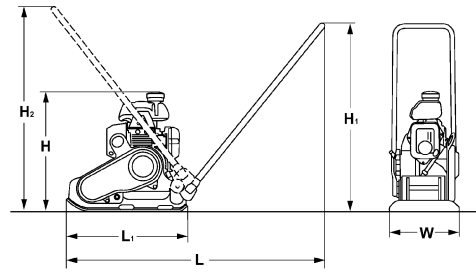

Standard Equipment

- Vibration insulated steering handle (BVP10/30)
- Detachable steering handle
- Highly wear resistant base plate (BVP10/30)
- Highly wear resistant cast iron base plate (BVP12/50A)
- Automatic shutdown at low oil level (BVP12/50A)
- Recoil starter
- Single point lifting device
- Fully protected V-belt
- Carrying handles
- 3-2-1 Warranty
- Sprinkler system (BVP12/50A)

Dimensions in inch

	H	H1	H2	L	L1	W
BVP 10/30	19.3	33.1	36.6	41.7	20.0	11.8
BVP 12/50 A	26.0	37.0	32.3	38.2	20.9	19.7

Optional Equipment

- Special painting
- Plastic mat (BVP10/30)
- Service Kit
- TOUGH WARRANTY (BVP12/50A)
- Comfort guide handle (BVP10/30)

Technical Data

Weights

Operating weight CECE	lb	104	159
Basic weight	lb	101	148

Dimensions

Working width	in	11.8	19.7
---------------------	----	------	------

Driving Characteristics

Working speed, max.	ft/min	82.0	82.0
Max. gradeability (dep. on soil con.)	%	30	30

Drive

Engine manufacturer		Honda	Honda
Type		GXR 120	GX 120
Emission stage		Stage V / CARB P.3	Stage V / CARB P.3
Cooling		air	air
Number of cylinders		1	1
Performance SAE J 1349	hp	2.8	3.5
Speed	rpm	3,600	3,600
Drive system		mech.	mech.
Fuel		Gasoline	Gasoline
Fuel consump. aver. during operation	gal/h	0.2	0.2

Exciter system

Frequency	vpm	100	92
Centrifugal force	lb	2,248/495	2,698/607
Amplitude	in	0.053	0.043

Capacities

Fuel	gal	0.2	0.5
Water	gal	-	1.8

Technical modifications reserved. Machines may be shown with options.



PRUS 834 19 010

070922 Sa05

BOMAG Americas, Inc.
 125 Blue Granite Parkway
 Ridgeway, SC 29130
 USA
 Tel. +1 803 3370700
 Fax +1 803 3370800
 www.bomag.com/us

